



LINN

English

Français

Deutsch

Español

Italiano

Nederlands

S I Z M I K 1 0 . 2 5 & 1 2 . 4 5

B A S S R E I N F O R C E M E N T L O U D S P E A K E R

OWNER'S MANUAL

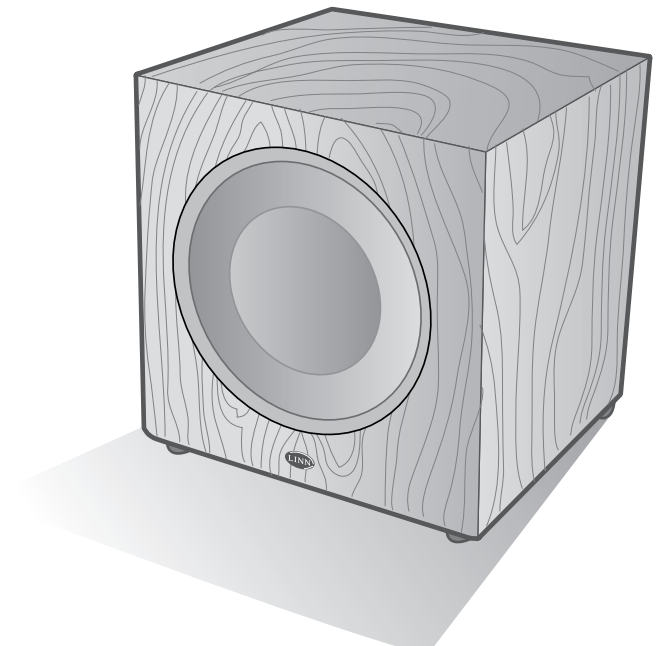

Important Safety Information

Explanation of symbols used in this manual and on the product:



This symbol is intended to alert the user to the presence of uninsulated dangerous voltages within the enclosure of sufficient magnitude to cause electric shock.



This symbol is intended to alert the user to the presence of important maintenance and servicing information in the instruction and service manuals.

CAUTION

TO REDUCE THE RISK OF ELECTRIC SHOCK DO NOT REMOVE THE COVER.
NO USER SERVICEABLE PARTS INSIDE.
REFER SERVICING TO QUALIFIED SERVICE PERSONNEL.
FOR CONTINUED PROTECTION AGAINST RISK OF FIRE, REPLACE ONLY WITH THE CORRECT TYPE OF FUSE.
DISCONNECT SUPPLY CORD BEFORE CHANGING FUSE.

WARNING

SHOCK HAZARD. DO NOT OPEN.
TO REDUCE THE RISK OF FIRE OR ELECTRIC SHOCK DO NOT EXPOSE THIS APPLIANCE TO RAIN OR MOISTURE.
THIS APPLIANCE MUST BE EARTHED.

MAINS PLUGS

This appliance is supplied with a non-rewireable mains plug for the intended country.
Replacement mains leads can be obtained from your Linn retailer.
Should you need to change the plug please dispose of it carefully.
A plug with bared conductors is dangerous if engaged in a live socket.
The Brown wire must be connected to the Live (Line) supply pin.
The Blue wire must be connected to the Neutral supply pin.
The Green/Yellow wire must be connected to the Earth (Ground) supply pin.
Please contact your retailer or a competent electrician if you are in any doubt.

General Safety Instructions

1. **Read instructions.** Read the safety and operating instructions before operating the appliance.
2. **Retain instructions.** Retain the safety and operating instructions for future reference.
3. **Heed warnings.** Observe all warnings on the appliance and in the operating instructions.
4. **Follow instructions.** Follow all operating and use instructions.
5. **Water and moisture.** Do not use the appliance near water, for example near a bathtub, washbowl, kitchen sink, laundry tub, in a wet basement, or near a swimming pool and the like.
6. **Carts and stands.** Use only with a cart or stand that is recommended by the manufacturer.
- 6a. An appliance and cart combination should be used with care. Quick stops, excessive force, and uneven surfaces may cause the appliance and cart combination to overturn.
7. **Wall or ceiling mounting.** Mount to a wall or ceiling only as recommended by the manufacturer.
8. **Ventilation.** Site the appliance so that its location or position does not interfere with its proper ventilation. For example, the appliance should not be situated on a bed, sofa, rug, or similar surface that may block the ventilation openings, or placed in a built-in installation such as a bookcase or cabinet that may impede the flow of air through the ventilation openings.
9. **Heat.** Site the appliance away from heat sources such as radiators, heaters, stoves, or other appliances (including amplifiers) that produce heat.
10. **Power sources.** Connect the appliance to a power supply only of the type described in the operating instructions or marked on the appliance.
11. **Grounding or polarisation.** Do not defeat the safety purpose of the polarised or grounding type plug. A polarised plug has two blades with one wider than the other. A grounding type plug has two blades and a third grounding prong. The wide blade or the third prong is provided for your safety. When the provided plug does not fit into your outlet, consult an electrician for replacement of the obsolete outlet.
12. **Power cord protection.** Route power cords so that they are not likely to be walked on or pinched by items placed upon or against them, paying particular attention to cords at plugs, power sockets, and at the point where they exit from the appliance.
13. **Mains plug.** Use the mains plug to disconnect the product from the mains supply. The mains plug must be accessible at all times. Use the mains switch (if applicable) when the product is not in use.
14. **Cleaning.** The product should be cleaned only as recommended by the manufacturer.
15. **Power lines.** An outdoor antenna should be located away from power lines.
16. **Outdoor antenna grounding.** If an outdoor antenna is connected to the tuner/receiver, ensure that the antenna system is grounded to provide some protection against voltage surges and static build up. In the USA see article 810 of the National Electrical Code ANSI/NFPA 70 concerning installation requirements.
17. **Telephone line.** Do not connect the product to a telephone line except where specifically instructed to do so.
18. **Lightning storms.** Unplug this apparatus during lightning storms or when unused for long periods of time.
19. **Objects and liquid entry.** Do not let objects or liquids fall into the product. Do not expose the product to dripping or splashing. Do not place a vessel containing liquid on top of the product.
20. **Damage requiring service.** The product should be serviced by qualified personnel if:
 - a) The power cord or plug has been damaged.
 - b) Objects or liquid have fallen into the product.
 - c) The product has been exposed to rain.
 - d) The product does not appear to operate normally or exhibits a marked change in operation.
 - e) The product has been dropped or the enclosure damaged.
21. **Servicing.** Do not attempt to service the product beyond that described in the operating instructions. All other servicing should be referred to qualified service personnel.



LINN

English

UK USERS PLEASE READ THIS IMPORTANT SAFETY INFORMATION

Replacing the fuse in the mains plug

This appliance is fitted with a non-rewireable 13 Amp mains plug. The plug contains a 5 Amp fuse. If the fuse has blown it can be replaced as follows:

- Pull out the red fuse cover/carrier.
- Remove and dispose of the blown fuse.
- Fit a new 5 Amp BS1362 approved fuse into the carrier and push the carrier back into the plug. Always ensure the fuse cover is fitted. If the fuse cover is missing do not use the plug. Contact your Linn retailer to obtain a replacement fuse cover. Fuses are for fire protection and do not protect against electric shock.

Mains plug replacement

Should your mains plug need replacing and you are competent to do this proceed as follows. If you are in doubt contact your Linn retailer or a competent electrician.

- Disconnect the plug from the mains supply.
- Cut off the plug and dispose of it safely. A plug with bared conductors is dangerous if engaged in a live socket.
- Only fit a 13 Amp BS1363A approved plug with a 5 Amp fuse.
- The cable wire colours or a letter will be marked at the connection points of most quality plugs. Attach the wires securely to their respective points. The Brown wire must go to the Live pin, the Blue wire must go to the Neutral pin, and the Green/Yellow wire must go to the Earth pin.
- Before replacing the plug top ensure that the cable restraint is holding the outer sheath of the cable firmly and that the wires are correctly connected.

WARNING THIS APPLIANCE MUST BE EARTHED.

Waste Electrical and Electronic Equipment (WEEE) Directive

Directive 2002/96/EC of the European Parliament and of the Council



The symbol (left) is shown on this product. It indicates that the product should not be disposed of with regular household waste, but should be disposed of separately.

Electrical and electronic equipment can contain materials that are hazardous to the environment and human health and therefore should be disposed of at a designated waste facility or returned to your retailer for the appropriate recycling to take place (see www.linn.co.uk for further information).

If you wish to dispose of this product and the product still functions, please consider recycling/reusing it by donating it to a charity shop, selling it or part-exchanging it with your retailer.

CE Declaration of Conformity

Linn Products Ltd declare that this product is in conformance with the Low Voltage Directive 73/23/EEC and Electromagnetic Compatibility 89/336/EEC as amended by 92/31/EEC and 93/68/EEC.

The conformity of the designated product with the provisions of Directive number 73/23/EEC (LVD) is proved by full compliance with the following standards:

Standard number	Date of issue	Test type
EN60065	2002	General requirements Marking Hazardous radiation Heating under normal conditions Shock hazards under normal operating conditions Insulation requirements Fault conditions Mechanical strength Parts connected to the mains supply Components Terminal devices External flexible cords Electrical connections and mechanical fixings Protection against electric shock Stability and mechanical hazards Resistance to fire

The conformity of the designated product with the provisions of Directive number 89/336/EEC (EMC) is proved by full compliance with the following standards:

Standard number	Date of issue	Test type
EN55013	2001	Conducted emissions
EN55013	2001	Absorbed emissions
EN55020	2002	Immunity

FCC notice

NOTE:

This equipment has been tested and found to comply with the limits for a Class B digital device, pursuant to Part 15 of the FCC Rules. These limits are designed to provide reasonable protection against harmful interference in a residential installation. This equipment generates, uses and can radiate radio frequency energy and, if not installed and used in accordance with the instructions, may cause harmful interference to radio communications. However, there is no guarantee that interference will not occur in a particular installation.

If this equipment does cause harmful interference to radio or television reception, which can be determined by turning the equipment off and on, the user is encouraged to try to correct the interference by one or more of the following measures:

- Reorient or relocate the receiving antenna.
- Increase the separation between the equipment and receiver.
- Connect the equipment into an outlet on a circuit different from that to which the receiver is connected.
- Consult the dealer or an experienced radio/TV technician for help.

Copyright and Acknowledgements

Copyright © Linn Products Limited. First edition September 2002.

Linn Products Limited, Glasgow Road, Waterfoot, Glasgow, G76 0EQ,
Scotland, United Kingdom.

All rights reserved. No part of this publication may be reproduced, stored in a retrieval system, or transmitted, in any form or by any means, electronic, mechanical, photocopying, recording, or otherwise, without the prior written consent of the publisher.

Printed in the United Kingdom.

SIZMIK, CHAKRA Linn and the Linn logo are trade marks of Linn Products Limited.

The content of this manual is furnished for informational use only, is subject to change without notice, and should not be construed as a commitment by Linn Products Limited. Linn Products Limited assumes no responsibility or liability for any errors or inaccuracies that may appear in this manual.



LINN

Introduction

The SIZMIK 10.25 and 12.45 are bass reinforcement loudspeakers designed for use in high-performance audio and audio/video entertainment systems. SIZMIK loudspeakers have been engineered to accurately reproduce the lowest frequencies of audio signals in order to enhance your enjoyment of music and movies. Your SIZMIK loudspeaker's features include seven adjustable parameters. These parameters give you precise control over the audio output from the loudspeaker, allowing for the performance of the unit to be altered to better reflect the characteristics of your other audio components and the acoustics of your room.

The SIZMIK loudspeakers incorporate CHAKRA, the very latest proprietary Linn power amplifier technology. CHAKRA perfectly combines the speed and precision of integrated MOSFET circuitry with smooth and highly robust discrete bipolar transistors for precisely controlled power at all listening levels.

Like the rest of Linn's loudspeaker range, the SIZMIK bass reinforcement loudspeakers exemplify our commitment to use the latest technology in order to continually improve the quality of our products. We are certain your SIZMIK loudspeaker will provide you with many years of superb performance.

Unpacking

The SIZMIK bass reinforcement loudspeaker is heavy: take care when removing it from its packaging.

The SIZMIK loudspeaker is supplied with the following accessories:

- mains lead
- phono lead
- warranty card
- this manual

We recommend that you retain the packaging in case you need to transport the SIZMIK loudspeaker at a later date.

Voltage selection

The SIZMIK contains an automatic internal mains voltage switch. This switch operates on all worldwide mains voltages from 100 V to 240 V. Manual adjustment on the SIZMIK for setting the input mains voltage is not possible.

Positioning

The SIZMIK loudspeaker can be placed anywhere you find convenient but please consider the following points:

- The SIZMIK loudspeaker is best suited to be positioned on a floor, not a table, shelf etc. It is heavy and must be stably supported.
- For best results position your SIZMIK loudspeaker as close as possible to either your left front or right front speaker.
- Bass notes will be accentuated if the SIZMIK loudspeaker is positioned close to a wall or in a corner.
- Experimenting with the position may be necessary in order to match the audio output of the SIZMIK loudspeaker with the acoustics of the room.

Cleaning

Disconnect the SIZMIK loudspeaker from the power supply before cleaning. Remove dust and fingerprints with a soft, dry cloth. Avoid using domestic cleaning products on the cabinet.

Connecting

Connect the SIZMIK loudspeaker to a mains supply using the mains lead provided.

IMPORTANT:

Do not turn on the mains supply until you have connected all other components.

Connecting to a Linn system controller or other AV processor

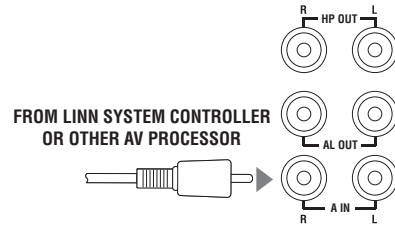

Connecting to a stereo preamplifier if used with large (full-range frequency response) loudspeakers.

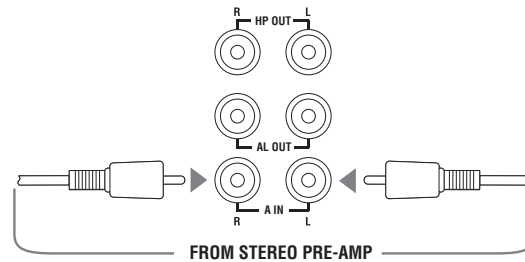

Connecting to a stereo preamplifier and power amplifier if used with small (limited bass response) loudspeakers.

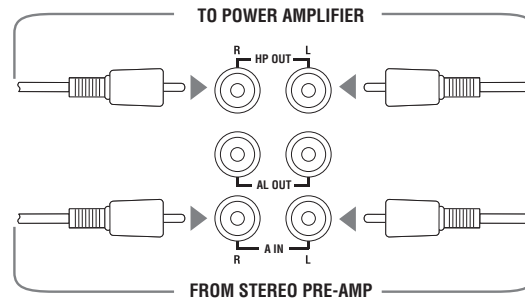

NOTE:

In the above configuration the SIZMIK loudspeaker is being used to stop low bass notes from being sent to the main loudspeakers.

Connecting to another SIZMIK loudspeaker

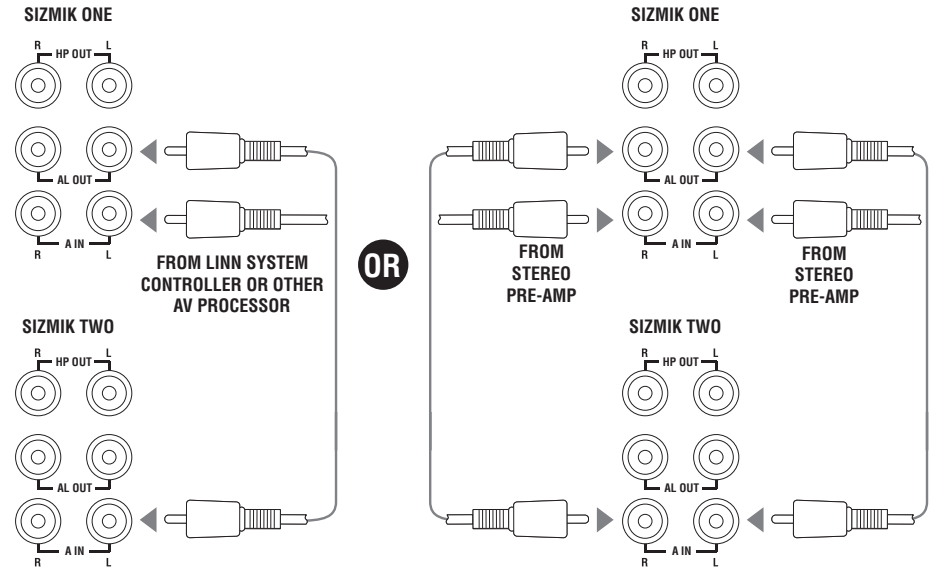

OR

Operating Modes

Key to symbols

SYMBOL	MODE	MEANING
◆	Standby	The unit is waiting for an audio signal In this mode the unit consumes minimal power.
—	On	The unit is fully powered-up The unit will enter this mode as soon as it receives an audio signal.
L.	Thermal Standby	The unit has overheated During very demanding, sustained use the unit will go into Thermal Standby mode in order to allow itself to cool down. When in this mode the unit will not produce any sound. The unit will return to On mode when its temperature has dropped to its operating level.

Parameters

The SIZMIK loudspeaker is equipped with seven adjustable parameters (see next page) that enable you to alter its performance to suit your taste.

NOTE:

The parameters can only be adjusted when the SIZMIK loudspeaker is not in standby mode.

Adjusting the parameters

To select the parameter you wish to adjust:

- Hold **FEATURE**.
- Repeatedly press **UP** or **DOWN** until the letter for the desired parameter appears.
- Release **FEATURE**.
- Repeatedly press **UP** or **DOWN** to change the setting.

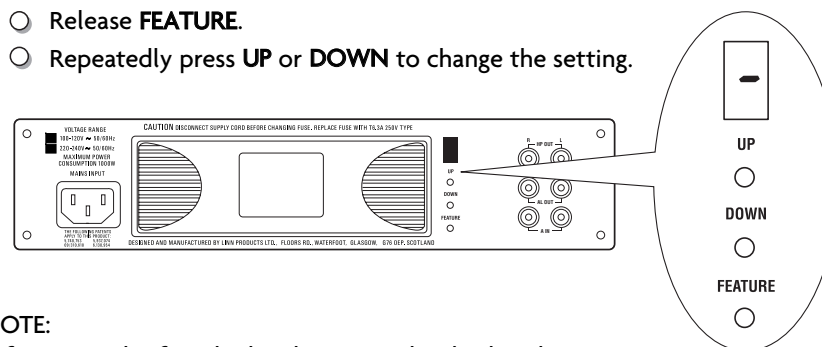

NOTE:

A few seconds after the last key press the display changes to —

To restore the factory defaults:

- Disconnect the SIZMIK loudspeaker from the mains supply and wait for the display to go blank.
- While holding **FEATURE** reconnect the mains supply.
- Continue to hold **FEATURE** until the display shows **H**
- Release **FEATURE**.

NOTE:

A few seconds after releasing **FEATURE** the display changes to —



LINN

English

Description and available settings for parameters

Default settings are shown in grey.

PARAMETER	SYMBOL	0	1	2	3	4	5	6	7	8	9
External high pass frequency* Increasing the setting reduces the bass content sent to the external speakers. (Hz)			10	50	75	100	115	135	160	190	235
Internal high pass frequency Increasing the setting raises the lowest frequency produced by the unit. (Hz)			18	22	25	30	34	40			
Internal low pass frequency** Reducing the setting lowers the highest frequency produced by the unit. (Hz)			55	85	130	NO FILTERING					

* Only for use when the SIZMIK loudspeaker is connected to a power amplifier (see *Connecting* section).

** If you are using the SIZMIK loudspeaker with a Linn system controller or other AV processor, set to 4 (No filtering).

PARAMETER	SYMBOL	0	1	2	3	4	5	6	7	8	9
Coarse gain Every one step increase in the setting raises the gain (volume) of the speaker by 5 decibels. Every one step decrease in the setting lowers the gain (volume) of the speaker by 5 decibels. (dB)			-15	-10	-5	0	+5	+10	+15		
Fine gain Every one step increase in the setting raises the gain (volume) of the loudspeaker by 1 decibel. (dB)		0	+1	+2	+3	+4					
Bass equalisation Every one step increase in the setting applies an additional 3 dBs at 30 Hz and below. (dB@30 Hz)		0	+3	+6							
Time out Length of time before unit will go into standby after audio input ceases. (mins)		ALWAYS ON	5	10	20						

Technical Specifications

SIZMIK 10.25

Type	1-way bass reinforcement
Mains input voltage	Voltage range
100 V	90 - 110 V
115 V	103 - 126 V
230 V	207 - 253 V
Mains supply frequency	50 - 60 Hz
External frequency response	Adjustable from 10 Hz - 235 Hz in 9 steps. Default is 10 Hz.
Internal frequency response	Adjustable from 55 Hz - 130 Hz in 3 steps and flat (to allow external low pass filtering). Default is 130 Hz.
Gain	Adjustable in 1 dB steps
Line input impedance	18 k Ω
Line output level	Electronically in parallel with line input
Output power	500 W RMS, 1000 W peak
Operating volume	25 litres
Dimensions	391 mm (H) x 360 mm (W) x 381 mm (D)
Weight	19 kg

SIZMIK 12.45

Type	1-way bass reinforcement
Mains input voltage	Voltage range
100 V	90 - 110 V
115 V	103 - 126 V
230 V	207 - 253 V
Mains supply frequency	50 - 60 Hz
External frequency response	Adjustable from 10 Hz - 235 Hz in 9 steps. Default is 10 Hz.
Internal frequency response	Adjustable from 55 Hz - 130 Hz in 3 steps and flat (to allow external low pass filtering). Default is 130 Hz.
Gain	Adjustable in 1 dB steps
Line input impedance	18 k Ω
Line output level	Electronically in parallel with line input
Output power	500 W RMS, 1000 W peak
Operating volume	45 litres
Dimensions	451 mm (H) x 420 mm (W) x 442 mm (D)
Weight	28 kg



LINN

English

Guarantee and Service

This product is guaranteed under the conditions which apply in the country of purchase and your statutory rights are not limited. In addition to any statutory rights you may have, Linn undertake to replace any parts which have failed due to faulty manufacture. To help us, please ask your Linn retailer about the Linn warranty scheme in operation in your country.

In parts of Europe, the United States of America and some other markets, extended warranty may be available to customers who register their purchase with Linn. A warranty registration card is included with the product and should be stamped by your retailer and returned to Linn as soon as possible. Alternatively, you can register your warranty online at www.linn.co.uk

Warning

Unauthorised servicing or dismantling of the product invalidates the manufacturer's warranty. There are no user serviceable parts inside the product and all enquiries relating to product servicing should be referred to authorised retailers only.

Technical support and information

For technical support, product queries and information, please contact either your local retailer or one of the Linn offices opposite.

Full details of your local retailer/distributor can be found on the Linn web site: www.linn.co.uk

Important

- Please keep a copy of the sales receipt to establish the purchase date of the product.
- Please ensure that your equipment is insured by you during any transit or shipment for repair.

Linn Products Limited

Glasgow Road
Waterfoot
Glasgow G76 0EQ
Scotland, UK

Phone: +44 (0)141 307 7777

Fax: +44 (0)141 644 4262

Helpline: 0500 888909

Email: helpline@linn.co.uk

Website: www.linn.co.uk

Linn Incorporated

8787 Perimeter Park Boulevard
Jacksonville
FL 32216
USA

Phone: +1 (904) 645 5242

Fax: +1 (904) 645 7275

Helpline: 888-671-LINN

Email: helpline@linninc.com

Website: www.linninc.com

Linn Deutschland GmbH

Albert-Einstein-Ring 19
22761 Hamburg
Deutschland

Phone: +49-(0) 40-890 660-0

Fax: +49-(0) 40-890 660-29

Email: info@linngmbh.de

Website: www.linn.co.uk